

WSP-BT200

(Kiosk&Ticket)

Rev. 2.0

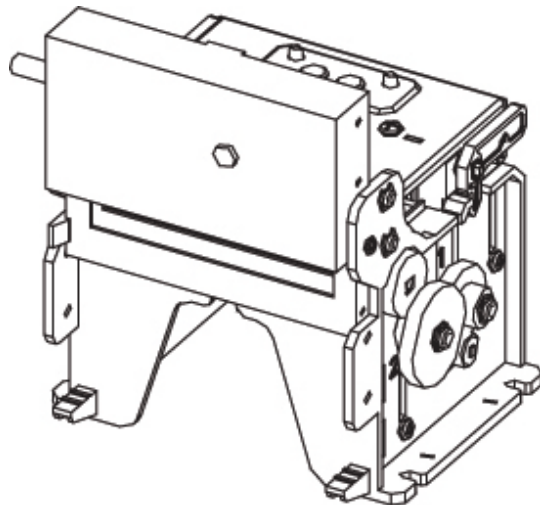

가 448 ,
3 501

: +82-2-2107-3700

: +82-2-2107-3707

<http://www.woosim.com>

||
WSP-BT200 Kiosk/Ticket
Copyright ©2008



||

가

|

150mm/sec high-speed

2

ATM, kiosks

u

u

(150mm/sec, MAX)

u

(203dpi : 8dots/mm)

u

u UART(RS-232C or TTL)

u

u CLAMSHELL

u

Door open & Paper-out

u

u

u

가

u

u Microsoft Windows 98 / ME / 2000 / XP / VISTA / 7

u

: (XON/XOFF)

u



I

U

•

•

: -10°C ~ 50°C

: 10% ~ 90%

•

•

•

•

IrDA

•

•

•

U

•

•

•

•

1.	6
1.1.	6
1.2	Part Number	6
1.3.	7
2.	8
2.1.	8
2.2.	9
2.3.	10
2.4.	12
2.5.	13
2.5.1.	13
2.5.2.	13
2.6.	14
3.	15
3.1.	UART(RS-232C or TTL)	15
4.	16
4.1.	16
4.2.	17
5.	18
5.1.	18
5.2.	18

1.

1.1.

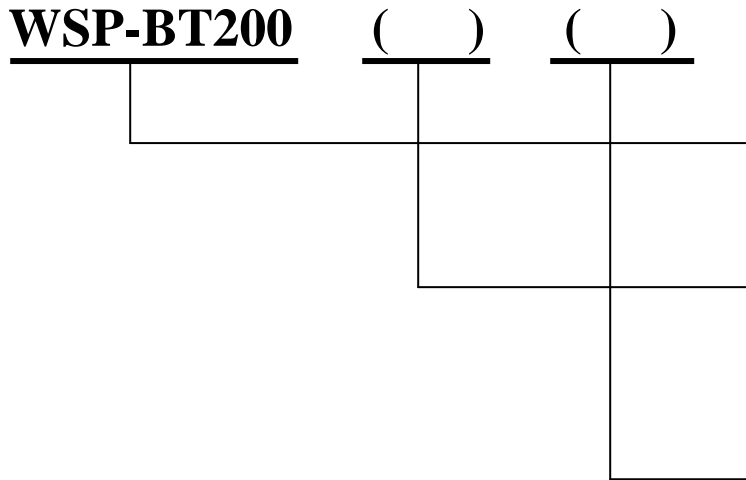

None : UART

None : DC 24V

1.2 Part Number

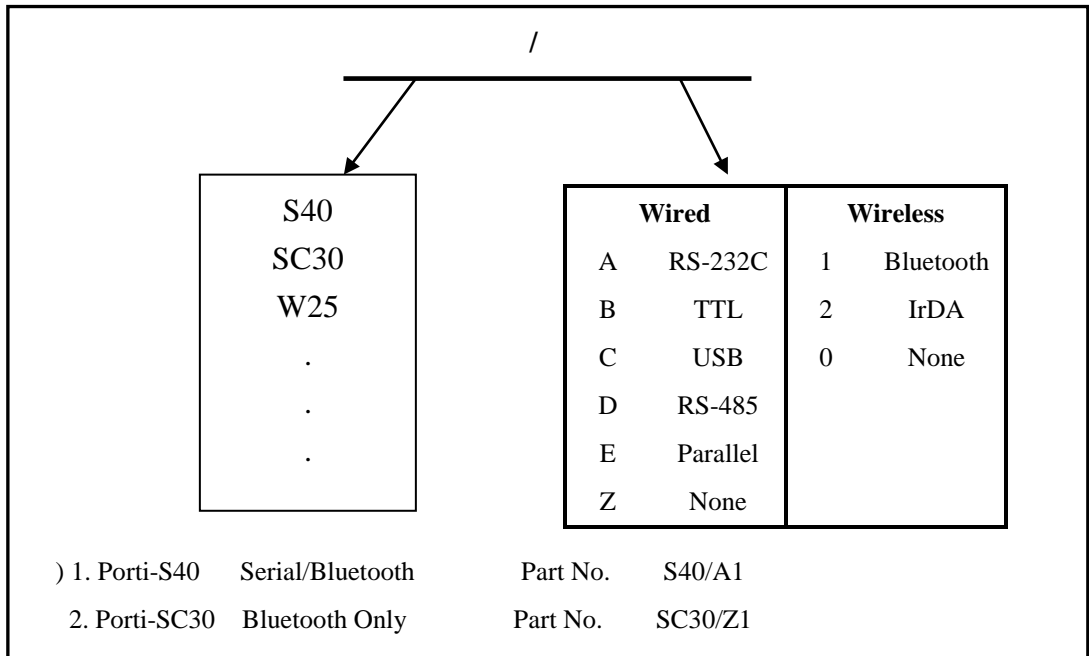

1.3.

		49cpl (MAX)
		: 9*24dots, 12*24dots : 16*24dots, [24*24dots]
		Simplified/Traditional Chinese, Arabic, Cyrillic, Russian, Turkish, Greek, Japanese, Persian, Latin9 and Others upon request.
		203dpi, 8dots/mm
		2-inch (56mm, 448dots)
		80 ± 0.5 mm wide(Thermal roll paper)
		150mm / sec (MAX)
		99.8 * 87.1 * 111.5(86.3) mm
		530g ()
		UART(RS-232C or TTL)
		1-dimension : Code128, Code39, I2/5, Code93 UPC, EAN,KAN, JAN, CODABAR 2-dimension : PDF417, QR Code, DATA Matrix
		MCU : 32bits RISC, FLASH : 4M bytes, RAM : 8M bytes
		1M byte
		24V DC, Max 3A
		-10°C ~ 50°C () -10°C ~ 70°C ()
		30% - 80% () 10% - 90% ()
MCBF (Mean Cycle Between failure)	Mechanical	37,000,000 lines
	Head	100 Km

< Table 1 >

2.

2.1.

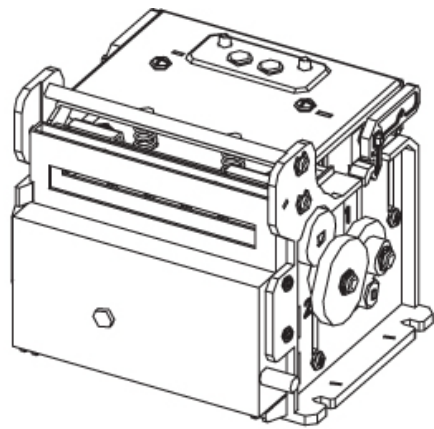
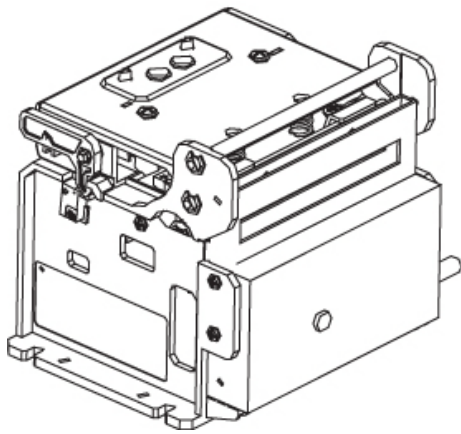

WSP-BT200

2.2.

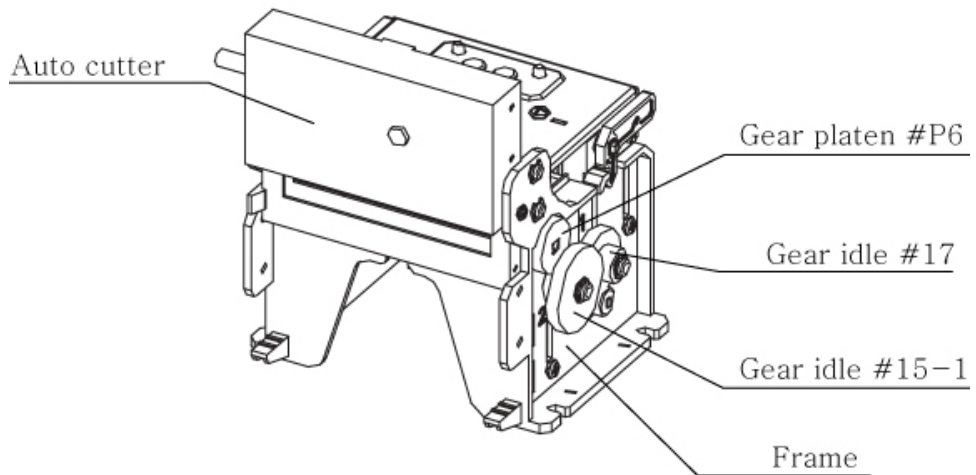
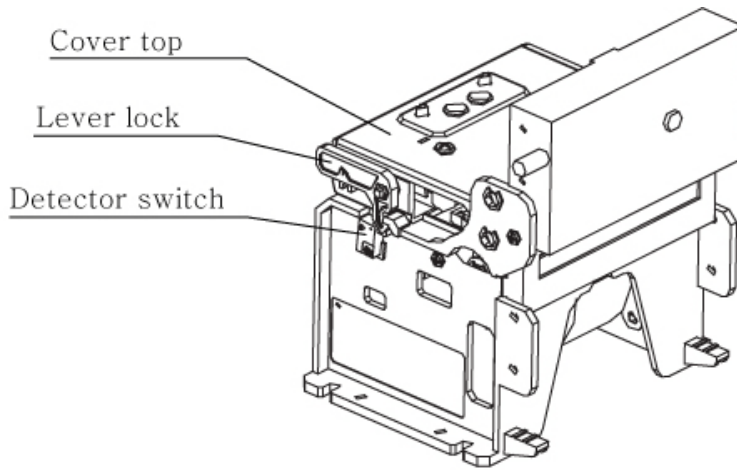

2.3.

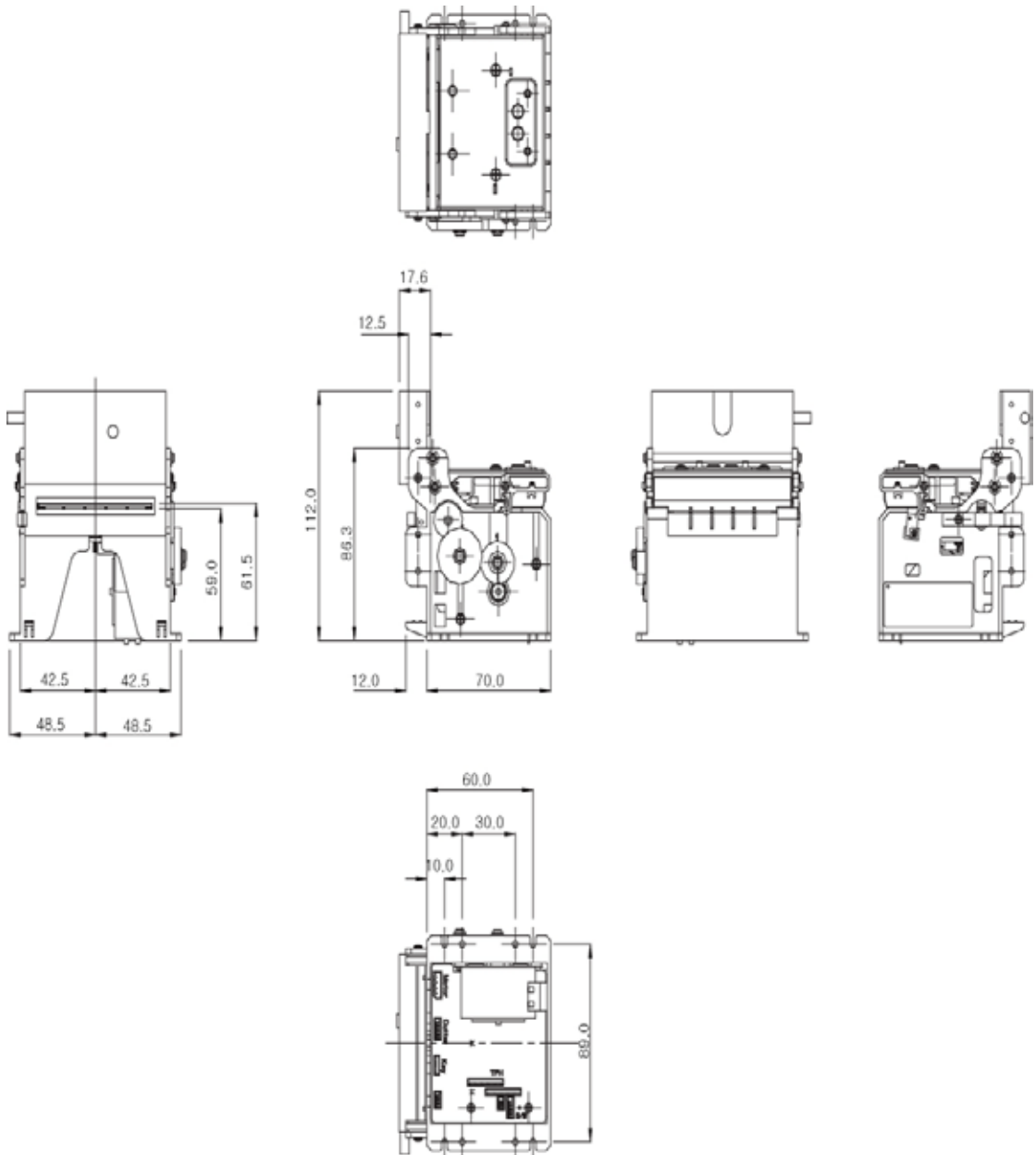

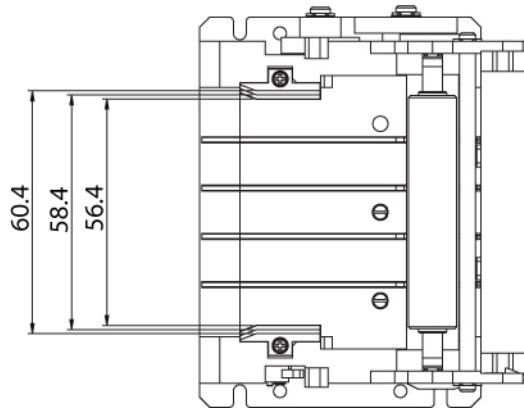

2.4.

: ,
(가 ,
.)

1. 가 . 가
가 .
2. Roll core 가 .
3. .

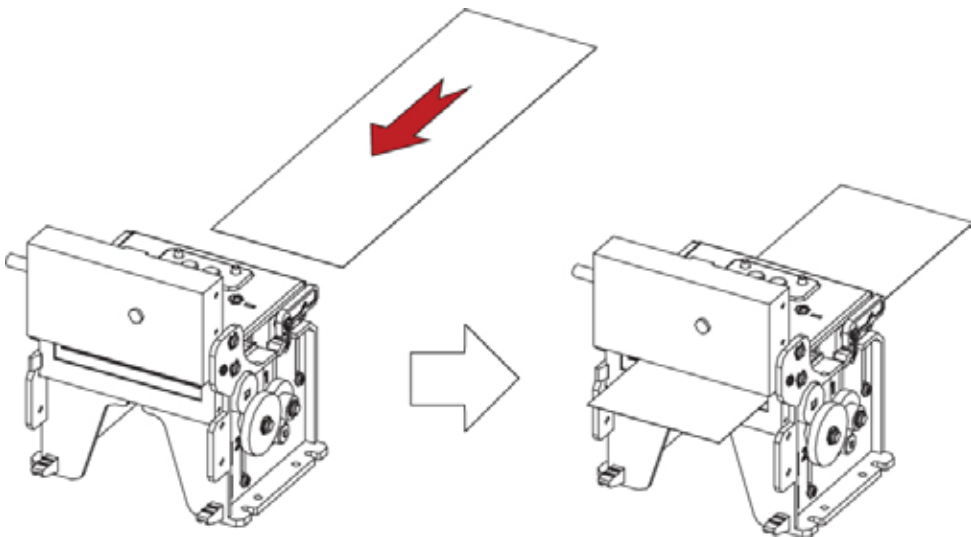

2.5.

2.5.1.

WSP-BT200

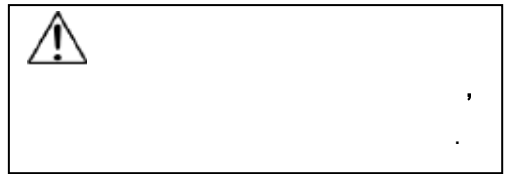
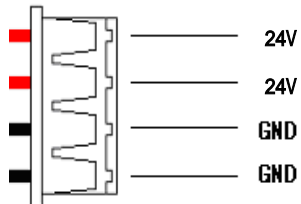

51004-0400 :

2.5.2.

: DC 24V / Max 3A

2.6.

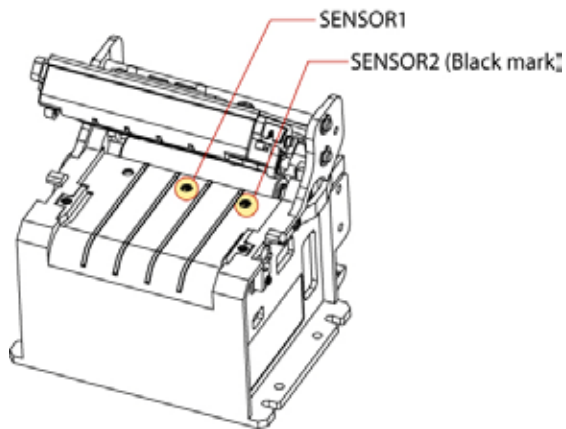
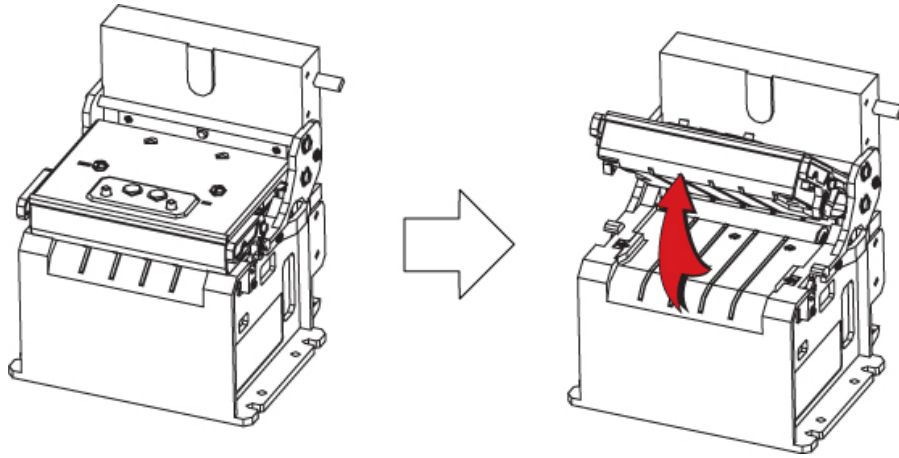

Sensor 1 : Paper Out Sensor

Sensor 2 : Black Mark Sensor

가

3.

3.1. UART(RS-232C or TTL)

WSP-BT200 UART(RS-232C or TTL) 가 , 3

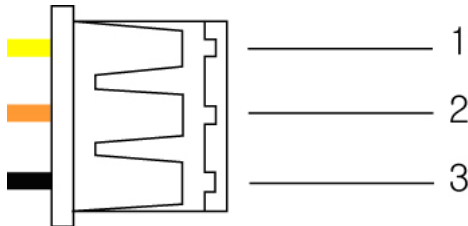

Pin No	Name	Direction	Function
1	TxD	Output	Transmit Data
2	RxD	Input	Receive Data
3	GND	-	Ground

<Molex : 51004-0300 >

Applicable connector : MOLEX 53014-0310 or equivalent.

4.

4.1.

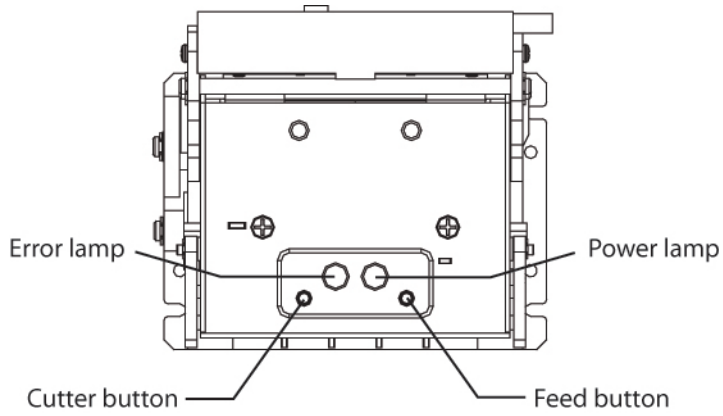

U

-

:

,

.

-

:

.

U

-

:

-

:

가

,

가

,

.

4.2.

가

1.

2.

3.

4.

5.

(

)

가

5.

5.1.

- :
- : 60mm
- : $60 \pm 5 \mu\text{m}$
- :



1. 가

2.

3. 70 , ,

4.

5.2.

